



The Society of Thoracic Radiology

THORACIC
and CARDIAC
IMAGING

March 25 - 29, 2007

Red Rock Casino, Resort & Spa
Las Vegas, Nevada

Annual Meeting & Postgraduate Course
www.thoracicrad.org



The Society of Thoracic Radiology

25th
Anniversary

1982 - 2007

Table of Contents

President's Letter	3
History	4
Founding Members	5
Course Description and Highlights	5
Course Objectives, Accreditation and Target Audience	6
Disclosures	6-8
Faculty	9-11
Contributors and Exhibitors	11
Future Meetings	12
General Information	12
Officers and Past Presidents	13
Program Committee and Guest Speaker	13
Meeting Schedule	14-23
Posters	25-64
Program Schedule	
Sunday, March 25, 2007	65
Monday, March 26, 2007	103
Tuesday, March 27, 2007	135
Wednesday, March 28, 2007	155
Thursday, March 29, 2007	203

President's Letter

Dear Fellow STR Members and Attendees:

The Society of Thoracic Radiology will hold its 2007 Annual Meeting and Postgraduate Course on March 25-29, 2007 at the Red Rock Casino, Resort & Spa in Las Vegas Nevada. This hotel is situated about 10 miles off of the Las Vegas strip near the Red Rock Mountains and is by all accounts fabulous. The course is designed for all physicians with an interest in cardiothoracic imaging. Dr. Jud Gurney has put together a wonderful program that includes dedicated symposia, small group workshops, expert film panels, scientific sessions and poster presentations. This year, there are three sessions dedicated to CT and MR imaging of cardiac disease. The Scanlon memorial symposium focuses on pulmonary physiology. Our Felson lecture will be delivered by Dr. H. Ric Harnsberger from the University of Utah whose talk is entitled "The Evolution of Information @ the Viewbox". The Society of Thoracic Radiology strongly encourages members and attendees to stay at the meeting hotel. In order to secure meeting room space for the course itself, the STR must reserve a block of guest rooms. If the meeting attendees do not use the rooms, the STR must pay the hotel for the excess reserved rooms. Las Vegas has much to offer members and their families. We look forward to seeing you at the meeting!

Sincerely,

A handwritten signature in black ink, appearing to read "HPMcAdams", with a long horizontal line extending to the right.

H. Page McAdams, MD
President, Society of Thoracic Radiology

Society of Thoracic Radiology History — 25th Anniversary

In the fall of 1982, 40 plus chest and cardiac radiologists met in a dingy hotel meeting room in Chicago to discuss the possible formation of a new society: The Society of Thoracic Radiology. The idea was the creation of Dr. S. David Rockoff, chairman of George Washington University Department of Radiology. He felt strongly that there was a need for an all inclusive society to represent the educational and research needs of pulmonary and cardiac radiology. The key words would be: “all inclusive” and “educational and research”. If you had an interest in cardiothoracic imaging, and it occupied a significant portion of your work week, you were invited to join. The yearly meeting would provide didactic lectures, seminars, research presentations, and posters in cardiothoracic imaging.

Dr. Rockoff believed that if the society could attract 75 members, it would be a viable organization. There were 117 members at the time of the first meeting. Today, there are 628 members from 30 nations a tribute to Dr. Rockoff’s foresight and the hard work of the founding members!

We are proud of the many accomplishments over the last 25 years. They include:

1. Yearly CME meetings, usually attended by 350 to 400 participants.
2. The annual Ben Felson lecture, bringing outstanding radiologists and non radiologists to our meeting, and the annual Gerard Scanlon Symposium, a focused session on a current topic of interest.
3. Under the direction of Dr. Eric Milne, and the STR, the Journal of Thoracic Imaging was founded approximately 20 years ago. It is now the official journal of the Society of Thoracic Radiology, the Japanese Society of Thoracic Radiology, and the Korean Society of Thoracic Radiology.
4. The society founded the STR Research Fund and the Jack Westcott Memorial Fund to encourage research in cardiothoracic imaging.
5. Under the direction of the Committee on Training and Standards, we worked with the ACR in developing standards for radiologic procedures, set out a suggested 4-year curriculum for radiology residents, and helped to set standards for fellowships in cardiothoracic imaging.
6. Our STR web site presents online presentation and lectures in cardiothoracic imaging, as well as syllabi from recent meetings.

We invite you to browse: www.thoracicrad.org

Society of Thoracic Radiology Founding Members

Herbert L. Abrams
Philip O. Alderson
John H.M. Austin
Howard J. Barnhard
Murray G. Baron
Hugo Bogren
Erik Carlsson
Jean Chalaoui
Larry P. Elliott
David S. Feigin
John J. Fennessy
Ernest J. Ferris
Irwin M. Freundlich
Warren B. Gefter
J. David Godwin
Lawrence R. Goodman
Philip C. Goodman
Thomas S. Harle
Claudia I. Henschke
Peter Herman
John T. Hsu
Herman Libshitz
Martin J. Lipton

Guy R. Matthew
Dorothy McCauley
Theresa C. McLoud
Stephen W. Miller
Wallace T. Miller
Richard A. Mintzer
John R. Muhm
John D. Newell
Bjorn E. Nordenstrom
Carl-Olof N.S. Ovenfors
Henry P. Pendergrass
Carl E. Ravin
Stanley B. Reich
Arvin E. Robinson
S. David Rockoff
Sanford A. Rubin
Stuart S. Sagel
H. Dirk Sostman
Robert M. Steiner
Frederick P. Stitik
Robert J. Tallaksen
Arl Van Moore
Jack F. Westcott

Course Description & Highlights

Thoracic and Cardiac Imaging 2007 is the Twenty-Fifth Annual Meeting and Postgraduate Course of the Society of Thoracic Radiology. This 5-day course features internationally recognized experts in thoracic imaging including the lungs, heart, thoracic vasculature, mediastinum, and pleura, and will include the following:

Dedicated Symposia on the following subjects:

- Coronary and cardiac Imaging (CT, MRI)
- Pulmonary vascular imaging
- HRCT of diffuse lung disease
- Solitary pulmonary nodule evaluation
- Evidence based medicine in thoracic imaging
- Lung cancer
- Congenital anomalies of the heart and lung
- Pulmonary infections: emerging viruses and Tb

Special Presentations by:

- A renowned radiologist and Chairman & CEO AMIRSYS, Inc. on “The Evolution of Information @ The Viewbox”
- A renowned expert in thoracic imaging on “Thoracic Imaging: Advancing From Structure to Function”

Scientific Sessions and Poster Presentations

Cardiac Imaging Workshop, up to 25 supervised cases applicable to ACR cardiac certification. Presenters will use workstations for case discussion.

Expert Film Panel that provides the “expert’s” approach to the differential diagnosis of unknown cases.

HRCT Unknown Film Panel will provide how to approach and evaluate the patient with diffuse lung disease.

Small-group Workshops by experts in thoracic imaging, focusing on topics such as Dictating Coronary CTA, Pediatric chest interpretation, Critical Care Radiology, Cardiopulmonary unknowns in a CAQ format, and Aortic arch anomalies.

Two Self-assessment Modules (SAMs) will be available for attendees to complete certified by the American Board of Radiology.

Course Objectives

At the completion of the course, the attendee will be able to

1. Summarize the role of imaging in the assessment of both ischemic and non-ischemic heart disease.
2. Summarize the state-of-the art evaluation of pulmonary physiology in thoracic imaging.
3. Recognize concepts in the evaluation, classification and treatment of congenital lesions of the heart, lungs, and airways.
4. Describe a multifaceted approach to the assessment of diffuse lung disease.
5. Comprehend the current concepts of evidence based medicine for radiologists.
6. Summarize the role of imaging in the assessment of the pulmonary arteries.
7. Describe technological advances in computed tomography (CT), magnetic resonance (MR) imaging, and positron emission tomography (PET) as they relate to chest disease.
8. Describe current and emergent issues in infectious diseases of the chest.
9. Comprehend the current status of interventional procedures of the chest, including ablation therapy of lung tumors.

Target Audience

This meeting is designed for general diagnostic radiologists, thoracic radiologists, cardiac radiologists, pulmonologists, internists, family physicians, thoracic surgeons, and chest-oriented residents and fellows with an interest in cardiac and pulmonary imaging.

Credit Information

The Society of Thoracic Radiology is accredited by the Accreditation Council for Continuing Medical Education to sponsor continuing medical education for physicians.

The Society of Thoracic Radiology (STR) designates this educational activity for a maximum of 39.25 *AMA PRA Category 1 Credits*[™]. Physicians should only claim credit commensurate with the extent of their participation in the activity.

Disclosures

As a provider accredited by ACCME, the Society of Thoracic Radiology must ensure balance, independence, objectivity and scientific rigor in its educational activities. Course Director(s), Planning Committee Members, Faculty, and all others who are in a position to control the content of this educational activity are required to disclose all relevant financial relationships with any commercial interest related to the subject matter of the educational activity. Safeguards against commercial bias have been put in place. Faculty will also disclose any off-label and/or investigational use of pharmaceuticals or instruments discussed in their presentation. Disclosure of these relevant financial relationships will be published in course materials so those participants in the activity may formulate their own judgments regarding the presentation.

Listed below are the *Twenty-Fifth Annual Meeting and Postgraduate Course* Course Director, Review Committee members, and Faculty

1) who have disclosed and the potential conflict has been resolved.

<u>Faculty Name</u>	<u>Pharmaceutical Company Name</u>	<u>What was Received/for What Role</u>
Philip N. Cascade, MD	MedSolutions, Inc.	fee, advisory committee
Jannette Collins, MD	Elsevier	royalty, editor, seminars in roentgenology
Philip Costello, MD	Berlex	honorarium – advisory board
Robert C. Gilkeson, Jr., MD	General Electric Healthcare Siemens	research grant research grant
J. David Godwin, MD	Actelion – consultant - consulting fee	
H. Ric Harnsberger, MD	Amirsys, Inc – CEO, salary, stock options	
Janet E. Kuhlman, MD	General Electric Healthcare	stock holder
Edward Y. Lee, MD, PhD	General Electric Healthcare	GEERAF research fellowship
David A. Lynch, MD	Interferon Intermune, Inc. Actecion, Inc. Encysive, Inc Amgen, Inc.	fee, consultant fee, consultant, advisory committee fee, consultant fee, consultant
H. Page McAdams, MD	Elsevier General Electric General Electric	royalty, textbook author shareholder grant to university
Alexander McGregor, MD	R2 Technology	financial
James G. Ravenel, MD	Imedex, Inc.	honorarium - speaker
U. Joseph Schoepf, MD	Siemens Medical Solutions General Electric Healthcare Bracco Diagnostics Medrad Inc.	research, consulting research, consulting research, consulting research, consulting
Robert M. Steiner, MD	Glaxo Smith Kline GE Amersham	research grant research grant
Shawn D. Teague, MD	Philips Medical Systems Beta Software	consultant – Lung CAD Program Evaluation Beta Tester
Eric vanSonnenberg, MD	Cook, Inc. Boston Scientific Valley Lab	honorarium – consultant honorarium – consultant honorarium - consultant

Ioannis Vlahos, MD	Siemens Siemens Medical Systems CAD Contracted Research Siemens Syngo Medical Advisory Board	Lung CAD FDA Advisory Committee, contracted research fee ChestCARE Software Platform Member, Medical Advisor
Charles S. White, MD	Philips Medical Systems	grant support - research

2) who declared no relevant financial relationship(s) with industry

<p>Gerald F. Abbott, MD Prachi P. Agarwal, MD Anil K. Attili, (A)FRCS, FRCR Anoop Ayyappan, MD Alexander A. Bankier, MD Andrew J. Bierhals, MD, MPH Naama R. Bogot, MD Phillip M. Boiselle, MD Alan S. Brody, MD Michael A. Brooks, MD Denis H. Carr, MD Marvin H. Chasen, MD, MSEE Caroline Chiles, MD Jesse Chusid, MD Paul P. Cronin, MD Carole J. Dennie, MD Benoit Desjardins, MD, PhD Vandana M. Dialani, MD Andre J. Duerinckx, MD, PhD Rosa M. Estrada-Y-Martini, MD Thomas Flukinger, MD Aletta A. Frazier, MD Jeffrey R. Galvin, MD Warren B. Gefter, MD Ritu R. Gill, MD Michelle S. Ginsberg, MD Gregory W. Gladish, MD Janel N. Glantz, MD Jonathan Goldin, MBChB, PhD Jin Mo Goo, MD, PhD Lawrence R. Goodman, MD Richard M. Gore, MD Marc V. Gosselin, MD Rolf A. Grage, MD Jud W. Gurney, MD Fernando R. Gutierrez, MD</p>	<p>David M. Hansell, MD Linda B. Haramati, MD Hiroto Hatabu, MD, PhD Todd R. Hazelton, MD Terrance Healey, MD Francine L. Jacobsen, MD, MPH Vineet R. Jain, MD Cylen Javidan-Nejad, MD S. Gregory Jennings, MD Jeffrey P. Kanne, MD Hans-Ulrich Kauczour, MD Aine M. Kelly, MD Loren H. Ketai, MD Arfa Khan, MD Jane P. Ko, MD Leon Kwok, MD Craig Labuda, MD Chang Hyan Lee, MD Eil Seong Lee, MD, PhD Kyung Soo Lee, MD Sebastian Ley, MD Rebecca M. Lindell, MD Diana Litmanovich, MD Howard Mann, MD Richard I. Markowitz, MD Edith M. Marom, MD Santiago Martinez, MD Georgeann McGuinness, MD Cris A. Meyer, MD Stephen W. Miller, MD Tan-Lucien H. Mohammed, MD Elizabeth Moore, MD William Moore, MD John D. Newell, Jr., MD Sandra A. Oldham, MD, FACR Narinder S. Paul, MD</p>	<p>Gregory D.N. Pearson, MD, PhD Perry G. Pernicano, MD Steven L. Primack, MD Zenon Protopapas, MD Carl E. Ravin, MD Gautham P. Reddy, MD, MPH Santiago E. Rossi, MD Anna Rozenshtein, MD Stuart S. Sagel, MD Ernest M. Scalzetti, MD Joon B. Seo, MD Rakesh D. Shah, MD Rosita M. Shah, MD Jo-Anne O. Shepard, MD Maria C. Shiau, MD Satinder P. Singh, MD William Stanford, MD Eric J. Stern, MD Diane C. Strollo, MD Yon Mi Sung, MD Robert D. Tarver, MD John Thiesing, MD Irena Tocino, MD Mylene T. Truong, MD Peter T. Verhey, MD Anna C. Walsham, MD John C. Wandtke, MD Jubal R. Watts, Jr., MD Markus Weininger, MD Gordon L. Weisbrod, MD Helen T. Winer-Muram, MD Florian Wolf, MD Chin A. Yi, MD Julia Zaporazhan, MD Carl J. Zylak, MD</p>
--	--	--

Faculty

Gerald F. Abbott, MD
Brown University

Prachi P. Agarwal, MD
University of Michigan

Anil K. Attili, (A) FRCS, FRCR
University of Michigan

Alexander A. Bankier, MD
University of Vienna

Andrew J. Bierhals, MD, MPH
Mallinckrodt Institute of Radiology

Naama R. Bogot, MD
University of Michigan

Phillip M. Boiselle, MD
Beth Israel Deaconess Medical Center

Alan S. Brody, MD
Children's Hospital Medical Center

Michael A. Brooks, MD
University of Kentucky

Denis H. Carr, MD
Royal Brompton Hospital

Philip N. Cascade, MD
University of Michigan

Marvin H. Chasen, MD, MSEE
MD Anderson Cancer Center

Caroline Chiles, MD
Wake Forest University

Jannette Collins, MD
University of Wisconsin

Philip Costello, MD
Medical University of South Carolina

Paul P. Cronin, MD
University of Michigan

Carole J. Dennie, MD
Ottawa Civic Hospital – Canada

Benoit Desjardins, MD, PhD
University of Michigan

Vandana M. Dialani, MD
Beth Israel Deaconess Medical Center

Andre J. Duerinckx, MD, PhD
Forsyth Radiological Associates

Rosa M. Estrada-Y-Martini, MD
University of Texas – Houston

Aletta A. Frazier, MD
Armed Forces Institute of Pathology

Jeffrey R. Galvin, MD
Armed Forces Institute of Pathology

Warren B. Gefter, MD
University of Pennsylvania

Robert C. Gilkeson, Jr., MD
University of Cleveland

Ritu R. Gill, MD
Brigham & Women's Hospital

Michelle S. Ginsberg, MD
Memorial Sloan-Kettering Cancer Center

Gregory W. Gladish, MD
MD Anderson Cancer Center

J. David Godwin, MD
University of Washington

Jonathan G. Goldin, MBChB, PhD
University of California – Los Angeles

Jin Mo Goo, MD, PhD
Seoul National University Hospital – Korea

Lawrence R. Goodman, MD
Medical College of Wisconsin

Richard M. Gore, MD
Evanston Hospital

Marc V. Gosselin, MD
Oregon Health and Science University

Rolf A. Grage, MD
Upstate Medical University

Jud W. Gurney, MD
University of Nebraska

Fernando R. Gutierrez, MD
Mallinckrodt Institute of Radiology

David M. Hansell, MD
Royal Brompton Hospital – United Kingdom

Linda B. Haramati, MD
Albert Einstein College of Medicine
Montefiore Medical Center

H. Ric Harnsberger, MD
University of Utah

Hiroto Hatabu, MD, PhD
Beth Israel Deaconess Medical Center

Todd R. Hazelton, MD
University of South Florida

Francine L. Jacobsen, MD, MPH
Brigham & Women's Hospital

Cylen Javidan-Nejad, MD
Mallinckrodt Institute of Radiology

Jeffrey P. Kanne, MD
The Cleveland Clinic

Hans-Ulrich Kauczor, MD
German Cancer Research Center

Aine M. Kelly, MD
University of Michigan

Loren H. Ketai, MD
University of New Mexico

Arfa Khan, MD
Long Island Jewish Medical Center

Jane P. Ko, MD
New York University

Janet E. Kuhlman, MD
University of Wisconsin

Craig Labuda, M.D.
Tripler Army Medical Center

Edward Y. Lee, MD, PhD
Children's Hospital - Boston

Eil Seong Lee, MD, PhD
Hallym University - Korea

Kyung Soo Lee, MD
Samsung Medical Center - Korea

Sebastian Ley, MD
German Cancer Research Center

Rebecca M. Lindell, MD
Mayo Clinic

Diana Litmanovich, MD
Beth Israel Deaconess Medical Center

David A. Lynch, MD
National Jewish Medical & Research Center

Howard Mann, MD
University of Utah

Richard I. Markowitz, MD
Children's Hospital of Philadelphia

Edith M. Marom, MD
MD Anderson Cancer Center

Santiago Martinez, MD
Duke University

H. Page McAdams, MD
Duke University

Georgeann McGuinness, MD
New York University

Stephen W. Miller, MD
Massachusetts General Hospital

Tan-Lucien H. Mohammed, MD
The Cleveland Clinic

Elizabeth H. Moore, MD
University of California – Davis

William H. Moore, MD
SUNY Upstate Medical University

John D. Newell, Jr., MD
National Jewish Medical & Research Center

Sandra A. A. Oldham, MD
University of Texas-Houston

Narinder S. Paul, MD
University of Toronto – Canada

Gregory D.N. Pearson, MD, PhD
Columbia University

Perry G. Pernicano, MD
University of Michigan

Steven L. Primack, MD
Oregon Health and Science University

Zenon Protopapas, MD
Yale University

James G. Ravenel, MD
Medical University of South Carolina

Carl E. Ravin, MD
Duke University

Gautham P. Reddy, MD, MPH
University of California – San Francisco

Santiago E. Rossi, MD
Dr. Enrique Ross Hospital – Argentina

Anna Rozenshtein, MD
Columbia University

Stuart S. Sagel, MD
Mallinckrodt Institute of Radiology

Ernest M. Scalzetti, MD
SUNY Upstate Medical University

U. Joseph Schoepf, MD
Medical University of South Carolina

Joon B. Seo, MD
Asan Medical Center – Korea

Rakesh D. Shah, MD
Northshore University Hospital

Rosita M. Shah, MD
Thomas Jefferson University

Jo-Anne O. Shepard, MD
Massachusetts General Hospital

Maria C. Shiau, MD
New York University

Satinder P. Singh, MD
University of Alabama

William Stanford, MD
University of Iowa

Robert M. Steiner, MD
Temple University

Eric J. Stern, MD
University of Washington

Diane C. Strollo, MD
University of Pittsburgh

Robert D. Tarver, MD
Indiana University

Shawn D. Teague, MD
Indiana University

John Thiesing, MD
Oregon Health & Science University

Irena Tocino, MD
Yale University

Mylene T. Truong, MD
MD Anderson Cancer Center

Eric vanSonnenberg, MD
St. Joseph's Hospital & Medical Center

Peter T. Verhey, MD
Oregon Health & Science University

Ioannis Vlahos, MD
New York University Medical Center

John C. Wandtke, MD
University of Rochester

Jubal R. Watts, Jr., MD
University of Alabama – Birmingham

Gordon L. Weisbrod, MD
Toronto Hospital – Canada

Charles S. White, MD
University of Maryland

Helen T. Winer-Muram, MD
Indiana University

Julia Zaporozhan, MD
German Cancer Research Center

Carl J. Zylak, MD
Henry Ford Hospital

Contributors and Exhibitors

General Electric Medical Systems
Fujifilm Medical Systems USA
Toshiba America Medical Systems, Inc.
Riverain Medical

Philips Medical Systems (in kind)
TeraRecon, Inc. (in kind)

EDDA Technology
Elsevier/Saunders/Mosby
Lippincott Williams-Wilkins

Upcoming Meetings

*Sanibel Harbour Resort & Spa
Ft. Meyers, Florida
February 28 – March 3, 2008*

Registration Hours

The registration desk will be located outside the general session room Summerlin ABEF at the resort:

Saturday, March 24, 2007	4:00 pm – 6:00 pm
Sunday March 25, 2007	6:30 am – 6:00 pm
Monday, March 26, 2007	6:30 am – 6:00 pm
Tuesday, March 27, 2007	6:30 am – 4:30 pm
Wednesday, March 28, 2007	6:30 am – 5:30 pm
Thursday, March 29, 2007	6:30 am – 12:15 pm

Speaker Preview Room

The speaker room located in the Trails room will be open as follows:

Saturday, March 24, 2007	2:00 pm – 9:00 pm
Sunday March 25, 2007	6:30 am – 6:00 pm
Monday, March 26, 2007	6:30 am – 5:30 pm
Tuesday, March 27, 2007	6:30 am – 4:30 pm
Wednesday, March 28, 2007	6:30 am – 5:30 pm
Thursday, March 29, 2007	7:30 am – 10:00 am

Society Membership Information

Membership in the Society of Thoracic Radiology is open to any radiologist who has an interest in thoracic radiology. If you are interested in receiving further information, contact:

Society of Thoracic Radiology
P.O. Box 7169
Rochester, MN 55903-7169
Telephone: (507)288-5620
Fax: (507)288-0014
E-mail: str@thoracicrad.org
Or visit the web at: www.thoracicrad.org

Society Officers

H. Page McAdams, MD
Jud W. Gurney, MD
Jeffrey S. Klein, MD

President
President-Elect
Immediate Past President

Jannette Collins, MD, MEd
Charles S. White, MD

Secretary
Treasurer

Society Past Presidents

S. David Rockoff, MD
Frederick P. Stitik, MD
Lawrence R. Goodman, MD
Harold Baltaxe, MD (deceased)
Carl J. Zylak, MD
Ernest J. Ferris, MD
Eric N.C. Milne, MD
Theresa C. McLoud, MD
David J. Delany, MD
Jack L. Westcott, MD (deceased)
W. Richard Webb, MD
Robert D. Pugatch, MD

J. David Goodwin II, MD
Sanford A. Rubin, MD
Nestor L. Muller, MD, PhD
Denise R. Aberle, MD
Robert M. Steiner, MD
Stephen J. Swensen, MD
Gordon Gamsu, MD
Jeffrey R. Galvin, MD
Robert D. Tarver, MD
Ella A. Kazerooni, MD
Reginald F. Munden, DMD, MD
Jeffrey S. Klein, MD

Program Committee

Program Committee

Jud W. Gurney, MD
Jannette Collins, MD
Charles S. White, MD
Phillip M. Boiselle, MD
Gerald F. Abbott, MD
Gautham P. Reddy, MD, MPH
Joel E. Fishman, MD
Robert C. Gilkeson, Jr., MD
Eric J. Stern, MD

Scientific Program Committee

Joel E. Fishman, MD, PhD
Sanjeev Bhalla, MD
Paul P. Cronin, MD
Sujal R. Desai, MD
Christopher A. Meyer, MD
Gautham P. Reddy, MD, MPH
Tan-Lucien Mohammed, MD

Invited Speakers for Thoracic and Cardiac Imaging 2007

Benjamin Felson Memorial Lecturer

"The Evolution of Information @ The Viewbox"

H. Ric Harnsberger, M.D.

Professor of Radiology

R.C. Wiley Chair in Neuroradiology

University of Utah

Chairman & CEO AMIRSYS, Inc.

Scanlon Symposium

Advancing from Structure to Function

Warren B. Gefter, M.D.

University of Pennsylvania

Society of Thoracic Radiology Scientific Program

March 25, 2007

Sunday

6:30 AM	Continental Breakfast	
7:00 AM	Scientific Session I	Joel E. Fishman, MD & Cristopher A. Meyer, MD
7:50 AM	Introduction and Welcome	H. Page McAdams MD Jud W. Gurney MD
Coronary CT		
<i>Moderator: Robert M. Steiner, MD</i>		
8:00 AM	CT & MR Anatomy of the Heart and Coronary Arteries (What the practicing radiologist needs to know)	William Stanford, MD
8:20 AM	Using the Correct Terminology: Coronary Artery Anatomy, Normal Variants and Anomalies	Cylen Javidan-Nejad, MD
8:40 AM	Technical Aspects of Obtaining High Quality CTA's of the Coronary Arteries	Shawn D. Teague, MD
9:00 AM	Coronary CTA: Image Post-processing	Michael A. Brooks, MD
9:20 AM	Coronary Artery CTA: Artifacts and Pitfalls	Aine M. Kelly, MD
9:40 AM	Coronary CTA: Read with the Expert	U. Joseph Schoepf, MD
10:00 AM	Questions and Discussion	Panel
10:15 AM	Break	
Coronary and Cardiac CT		
<i>Moderator: Jo-Anne O. Shepard, MD</i>		
10:30 AM	Coronary Artery CTA in Low-risk Patients: Impact on the Practice of Medicine	Andre J. Duerinckx, MD, PhD
10:50 AM	Cardiac CT: Case Examples, Report Essentials and Clinical Implications of Findings	Peter T. Verhey, MD
11:10 AM	Cardiac CT of the Left Atrium and Pulmonary Veins	Paul P. Cronin, MD
11:30 AM	Non-ischemic Myocardial Disease	Narinder S. Paul, MD
11:50 AM	Questions and Discussion	Panel
12:10 PM	<i>Lunch (on own)</i>	
12:10 PM	<i>25th Anniversary Founding Members Lunch (for founding members only)</i>	

MR–CT Cardiac Evaluation

Moderator: Gautham P. Reddy, MD, MPH

1:10 PM	MR/CT for Cardiac Electrophysiology	Benoit Desjardins, MD, PhD
1:30 PM	Imaging of the Heart Transplant	Naama L. Bogot, MD
1:50 PM	MR Imaging of Cardiomyopathies: Can We Tell Them Apart	Zenon Protopapas, MD
2:10 PM	Imaging of the Heart Valves, Pre- & Post-op on CT, MRI, Fluroscopy	Andrew J. Bierhals, MD, MPH
2:30 PM	Methods for Extracting Quantitative Data from CT and MRI	Gautham P. Reddy, MD, MPH
2:50 PM	Cardiovascular MRI in Ischemic Heart Disease	Anil K. Attili, M.D.
3:05 PM	Break	

Cardiac Applications

Moderator: Charles S. White, MD

3:20 PM	Skeletal Findings in Heart Disease	Fernando R. Gutierrez, MD
3:40 PM	Cardiac Imaging in Oncology	Gregory W. Gladish, MD
4:00 PM	Cardiopulmonary Disease in Women	Vandana M. Dialani, MD
4:20 PM	Chest Pain in the ED, What is the Role of MDCT?	Charles S. White, MD
4:40 PM	Questions and Discussion	Panel

5:00 PM UNKNOWN FILM PANEL

Moderator: Phillip M. Boiselle, MD

Panelists: Jannette Collins, MD
 J. David Godwin, MD
 Lawrence R. Goodman, MD
 Jud W. Gurney, MD
 H. Page McAdams, MD
 Jo-Anne O. Shepard, MD
 Robert M. Steiner, MD
 Charles S. White, MD

6:30 PM Adjourn for day

6:30 – 8:00 PM *STR Reception*

March 26, 2007

Monday

6:30 AM	Continental Breakfast	
7:00 AM	Scientific Session II	Gautham P. Reddy, MD, MPH & Jonathan A. Leipsic, MD
8:00 AM	Case of the Day	John Thiesing, MD
8:10 AM	Case of the Day	Santiago Martinez, MD
8:20 AM	Case of the Day	Diana Litmanovich, MD

Cardiac Imaging

Moderator: Carl Zylak, MD

8:30 AM	Incidental Cardiac Findings on Chest CT	Elizabeth H. Moore, MD
8:50 AM	Adult Congenital Heart Disease - Classification & Complications	Linda B. Haramati, MD
9:10 AM	Novel Treatments of Heart Failure. Part I: Mechanical Devices	Phillip N. Cascade, MD
9:30 AM	Novel Treatments of Heart Failure. Part II. Non-mechanical Methods	Prachi P. Agarwal, MD
9:50 AM	CT of Pericardium	Stuart S. Sagel, MD
10:10 AM	Questions and Discussion	Panel
10:25 AM	Break	

Pulmonary Vascular Imaging (SAMs)

Moderator: Arfa Khan, MD

10:40 AM	Pulmonary Embolus: MDCT Evaluation, How I Do It	Janet E. Kuhlman, MD
11:00 AM	Chronic Thromboembolic PAH	Carole J. Dennie, MD
11:20 AM	CTPA as the Gold Standard for the Diagnosis of PE:Survey Results	Sandra A. A. Oldham, MD, FACR & Rosa Estrada-y-Martin, MD, FCCP
11:40 AM	Pulmonary Vascular Disease Other Than Thromboembolism	Joon Beom Seo, MD
12:00 PM	Obstructive Lesions of the Capillaries and Post-capillary Circulation	Aletta A. Frazier, MD

12:20 PM Questions and Discussion Panel

12:30 PM *Business Meeting and Lunch (for STR members only)*

HRCT of Diffuse Lung Disease (SAMs)

Moderator: Caroline Chiles, MD

2:30 PM Patterns on HRCT Eric J. Stern, MD

2:50 PM HRCT: The Borderlands of Normal David M. Hansell, MD

3:10 PM Smoking Related ILD Jeffrey R. Galvin, MD

3:30 PM IPF and Other Interstitial Pneumonia David A. Lynch, MD

3:50 PM Small Airway Disease Santiago E. Rossi, MD

4:10 PM New Classification System in Pediatric Interstitial Lung Disease Alan S. Brody, MD

4:30 PM Break

4:45 PM **Silver Anniversary Lecture: “The Optimal Chest X-Ray”** Carl E. Ravin, MD

5:00 PM **Gold Medal Award Presentation** Moderator: H. Page McAdams, MD

5:10 PM ***Benjamin Felson Memorial Lecture:***

“The Evolution of Information @ The Viewbox”

H. Ric Harnsberger, MD
Professor of Radiology
R.C. Wiley Chair in
Neuroradiology
University of Utah
Chairman & CEO AMIRSYS, Inc.

6:00 PM Adjourn for day

March 27, 2007

Tuesday

6:30 AM	Continental Breakfast	
7:00 AM	Case of the Day	Rebecca M. Lindell, MD
7:10 AM	Case of the Day	Tan-Lucien H. Mohammed, MD
7:20 AM	Case of the Day	Ritu R. Gill, MD
7:30 AM	Case of the Day	Zenon Protopapas, MD

Scanlon Symposium I – Pulmonary Physiology

Moderator: Jud W. Gurney, MD

7:40 AM	Scanlon Symposium Introduction	Jud W. Gurney, MD
	Scanlon Lecture	
7:45 AM	Thoracic Imaging: Advancing from Structure to Function	Warren B. Gefter, MD
8:30 AM	Basic Lung Physiology for the Thoracic Radiologist	Alexander A. Bankier, MD
8:50 AM	Lung Function Tests: How PFT Results Integrate with CT Findings	Howard Mann, MD
9:10 AM	Contrast Dynamics: Physiologic Clues of Cardiopulmonary Status	Marc V. Gosselin, MD
9:30 AM	Break	

Scanlon Symposium II – Pulmonary Physiology

Moderator: Hiroto Hatabu, MD

9:45 AM	Is Image-based Spirometry Feasible?	Hans-Ulrich Kauczor, MD
10:05 AM	Imaging Gas Exchange	Hiroto Hatabu, MD, PhD
10:25 AM	Functional CT in COPD: Structure vs Function	Jonathan G. Goldin, MBChB, PhD
10:45 AM	Tracheomalacia	Phillip M. Boiselle, MD
11:05 AM	Functional Lung Imaging with Hyperpolarized Helium MRI	Georgianne McGuinness, MD
11:25 AM	Break	

Solitary Pulmonary Nodule

Moderator: Helen Winer-Muram, MD

- 11:40 AM Characterization of SPN Using CT and PET Kyung Soo Lee, MD
- 12:00 PM Developments in CAD: Nodule Detection and Evaluation Ioannis Vlahos, MD
- 12:20 PM Lung Biopsy Elizabeth H. Moore, MD
- 12:40 PM Cryoablation of Pulmonary Malignancies William H. Moore, MD
- 1:00 PM *Lunch (on own)*
- 2:00 PM **ACR Cardiac Imaging Workshops** **Moderator: Robert C. Gilkeson, Jr., MD**
- Presenters: Andre Duerinckx, MD
Robert C. Gilkeson, Jr., MD
Gautham P. Reddy, MD, MPH
Satinder P. Singh, MD
Shawn D. Teague, MD
- 5:00 PM Adjourn for day
- 6:30 PM *Past Presidents Reception & Dinner (invitation only)*

March 28, 2007

Wednesday

6:30 AM	Continental Breakfast	
7:00 AM	Scientific Session III	Tan-Lucien H. Mohammed, MD & Paul P. Cronin, MD
8:00 AM	Case of the Day	Craig LaBuda, MD
8:15 AM	Awards Session	

Concurrent Session A: Back to Basics

Moderator: Robert D. Tarver, MD

(Main Ballroom)

8:30 AM	Airways Disease: Anatomy-Radiology-Pathology Correlation	Gerald F. Abbott, MD
8:50 AM	Localization of Intrathoracic Lesions by Silhouette Sign	Eil Seong Lee, MD, PhD
9:10 AM	Lateral Chest Radiograph: The Forgotten View	Rakesh D. Shah, MD
9:30 AM	Chest Radiograph: How Much Information is There	Denis H. Carr, MD
9:50 AM	Plain Radiography of Obstructive Airway Disease with CT Correlation	John D. Newell, Jr. MD
10:10 AM	Chronic alveolar disease: Often Missed Diagnoses	Rosita M. Shah, MD

Concurrent Session B: Evidence Based Medicine

Moderator: Irena Tocino, MD

(Veranda AB)

8:30 AM	Evidence Based Medicine	Aine M. Kelly, MD
8:50 AM	Evidence Based Pathways and Utilization	Irena Tocino, MD
9:10 AM	EBM, How Can One Apply It To Thoracic Radiology?	Howard Mann, MD
9:30 AM	SPN, Evidence Based Management	Anil K. Attili, MD
9:50 AM	Lung Cancer, EBM Approach to Mediastinal Staging	James G. Ravenel, MD
10:10 AM	Computer-aided Diagnosis in Chest CT	Jin Mo Goo, MD, PhD
10:25 AM	Break	

Concurrent Session C: Lung Cancer

Moderator: Gerald F. Abbott, MD

(Main Ballroom)

10:40 AM	Epidemiology of Lung Cancer	Michelle S. Ginsberg, MD
11:00 AM	Role of PET-CT in Lung Cancer	Marlene T. Truong, MD
11:20 AM	Pulmonary Manifestations of Novel Cancer Therapies	Edith M. Marom, MD
11:40 AM	Metastatic Disease to the Chest and Follow-up of Pulmonary Nodules	Gordon L. Weisbrod, MD
12:00 PM	Ablation of Thoracic Tumors and Lung Cancer Metastases	Eric vanSonnenberg, MD

Concurrent Session D: Lung Infections

Moderator: Jane P. Ko, MD

(Veranda AB)

10:40 AM	Emerging Viral Infections	Loren H. Ketai, MD
11:00 AM	Pulmonary Infections, Including New Advances in Imaging Tuberculosis	Anna Rozenshtein, MD
11:20 AM	Spectrum of Pulmonary Infection in Hematopoietic Stem Cell Transplantation	Todd R. Hazelton, MD
11:40 AM	Atypical Mycobacteria	Jane P. Ko, MD
12:00 PM	Questions and Discussion	Panel
12:20 PM	<i>Lunch (on own)</i>	

Workshops I-III

Moderator: Stephen W. Miller, MD

(Main Ballroom)

1:20 PM	Cardiopulmonary Unknowns – A Sample CAQ Examination	Stephen W. Miller, MD
2:00 PM	Coronary CT Angiography	Satinder P. Singh, MD
2:40 PM	Coronary CTA with Examples of Dictation	Gregory D.N. Pearson, MD, PhD

Wednesday

Workshops IV-VI

Moderator: Steven L. Primack, MD

(Veranda AB)

- | | | |
|---------|---|--------------------------|
| 1:20 PM | Pediatric Chest Interpretation, Interactive Case Review | Richard I. Markowitz, MD |
| 2:00 PM | Pulmonary Manifestations of Abdominal Disease | Richard M. Gore, MD |
| 2:40 PM | Thoracic Imaging in the ICU | Steven L. Primack, MD |
| 3:20 PM | Break | |

Workshops VII-IX

Moderator: Marc V. Gosselin, MD

(Veranda AB)

- | | | |
|---------|--|----------------------------|
| 3:40 PM | Aortic Arch Anomalies in Adults, New Observations and Concepts | Marvin H. Chasen, MD, MSEE |
| 4:20 PM | Evaluating the Myths of Cardiopulmonary Imaging Dogma | Marc V. Gosselin, MD |
| 5:00 PM | MDCT Evaluation of Congenital Lung Disease in Pediatric Patients | Edward Y. Lee, MD, PhD |

Workshops X-XII

Moderator: Philip Costello, MD

(Main Ballroom)

- | | | |
|--------------|--|--|
| 3:40 PM | HRCT Unknown Film Panel | |
| | Participants: | Arfa Khan, MD
Edith M. Marom, MD
Georgann McGuinness, MD
Diane C. Strollo, MD |
| 5:40 PM | Adjourn for day | |
| 5:45–7:00 PM | <i>Student/Fellow/Resident Reception</i> | |

March 29, 2007

Thursday

7:30 AM	Continental Breakfast	
8:00 AM	Case of the Day	Jubal R. Watts, MD
8:10 AM	Case of the Day	Rolf A. Grage, MD
8:20 AM	Case of the Day	Perry Pernicano, MD

Congenital Problems

Moderator: H. Page McAdams, MD

8:30 AM	Congenital Anomalies and Disease of the Thoracic Aorta	Jeffrey P. Kanne, MD
8:50 AM	Congenital Diseases of the Thorax in Adults	Maria C. Shiau, MD
9:10 AM	Preoperative Assessment and Follow-up of Congenital Abnormalities of the Pulmonary Arteries Using CT and MRI	Sebastian Ley, MD
9:30 AM	Morphological and Functional Imaging of Congenital Airway Obstruction	Julia Zaporozhan, MD
9:50 AM	Questions and Discussion	Panel
10:05 AM	Break	

Common Problems

Moderator: Jud W. Gurney, MD

10:20 AM	Asbestos Related Pleural Disease and Mesothelioma	Francine L. Jacobson, MD, MPH
10:40 AM	The Many Faces of Aspiration	H. Page McAdams, MD
11:00 AM	Radiographic Detection of Pneumothorax	Ernest M. Scalzetti, MD
11:20 AM	The Diaphragm: Hernias, Paralysis, and Peri-diaphragmatic Disease	John C. Wandtke, MD
11:40 AM	Atelectasis: A Documentary	Jud W. Gurney, MD
12:00 PM	Questions and Discussion	Panel
12:30 PM	<i>End of Course</i>	

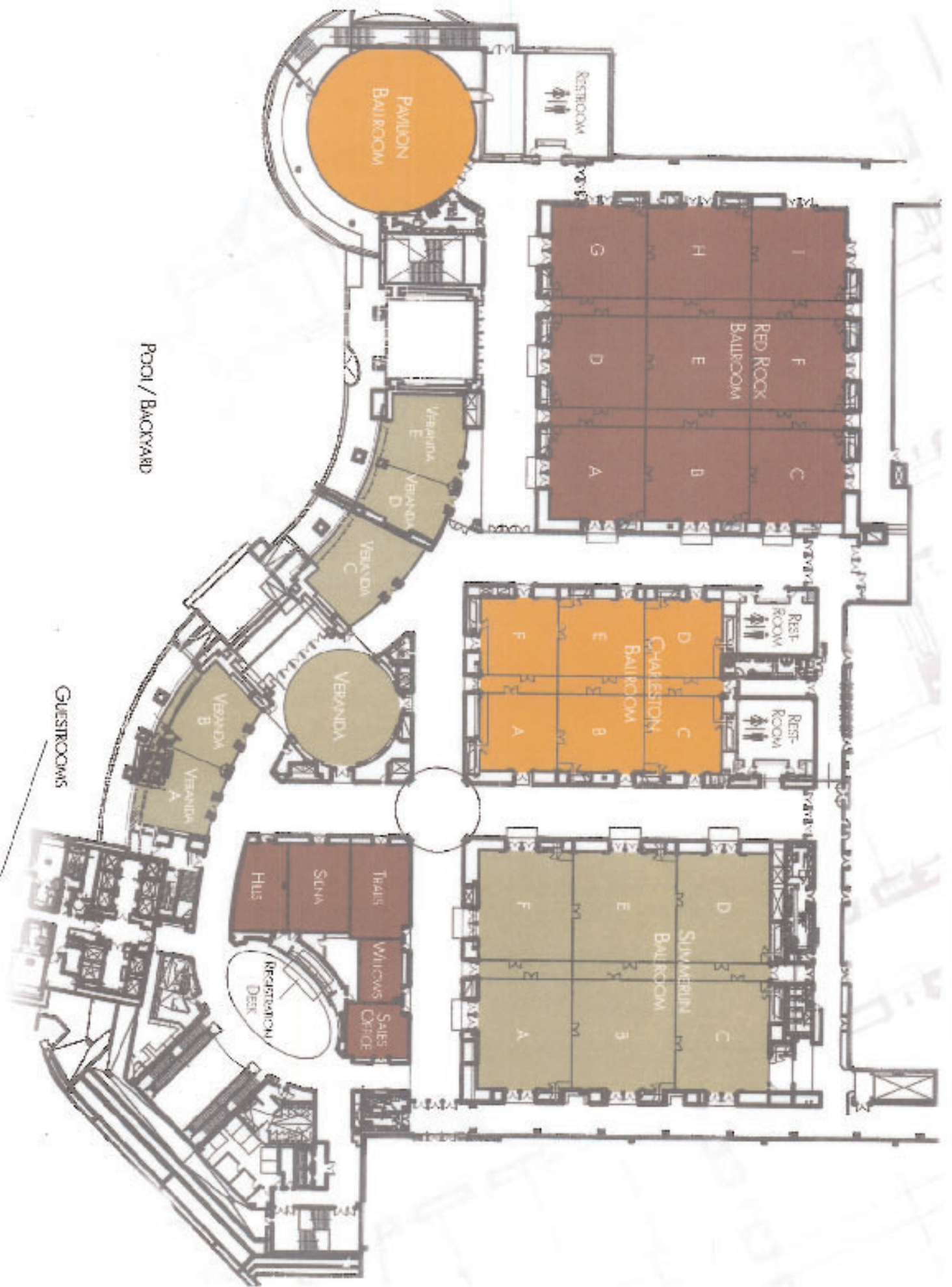

Architectural drawing showing a floor plan of a building with various rooms and areas. The plan includes a large circular area labeled "Pavilion Ballroom" (orange), a rectangular area labeled "Red Rock Ballroom" (dark red) divided into rooms A-I, a rectangular area labeled "Charleston Ballroom" (orange) divided into rooms A-F, and another rectangular area labeled "Silverstein Ballroom" (olive green) divided into rooms A-F. Other rooms include "Rest Room", "Guestrooms", "Veranda" (A-E), "Recreation Deck", "Hills", "Senia", "Trails", "Willows", and "Sales Office". A "Pool / Backyard" area is indicated near the Pavilion Ballroom. The drawing is oriented vertically on the page.